

The third year project - functional capacity evaluator hand-grip case

Solid works model of the functional capacity evaluator hand grip case

Introduction: the function of the case is to get data from workers who recover from massive injury while they're doing the exercises. Then we can use data to judge what is the maximum strength he can use and if he can continue to work. ensure that the workers can carry out their work safely.

Material: ABS (Acrylonitrile butadiene styrene)

Benefits:

1. Strong impact resistance
2. Strong heat resistance
3. High tensile strength
4. Shock absorbance
5. Scratch resistance
6. Low cost

the extrude body for supporting the screen when it insert in bottom of the case

the extrude body make the slide port can successfully slide along the groove in the bottom and top of case

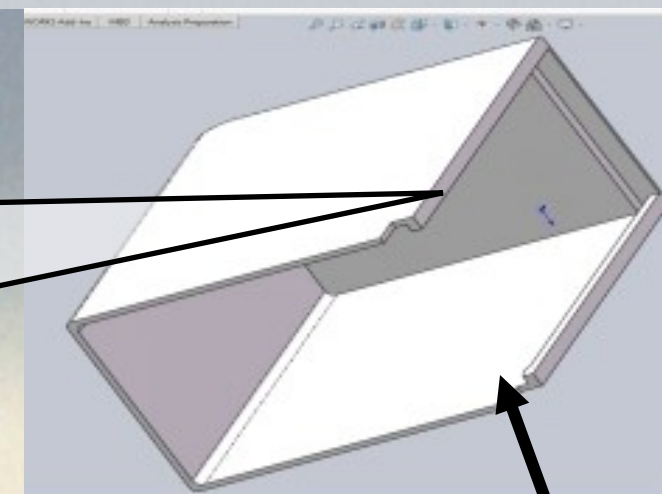

Slide port

This empty rectangle part is for the screen, the size is about 60mm×87mm.

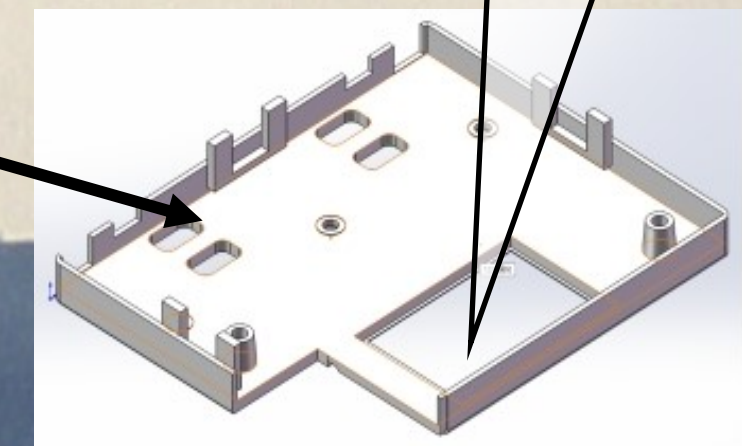

Top of the case

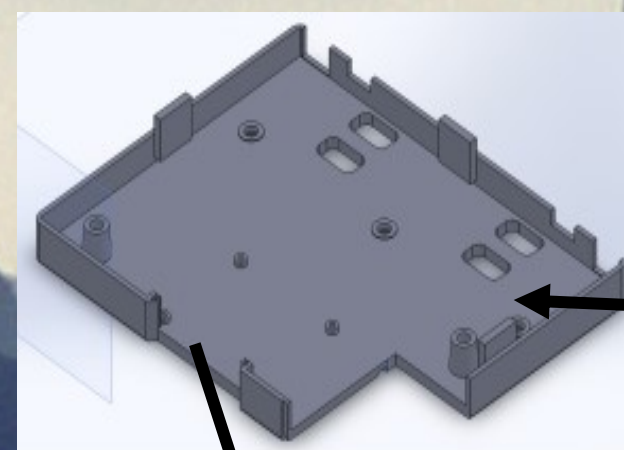

Bottom of the case

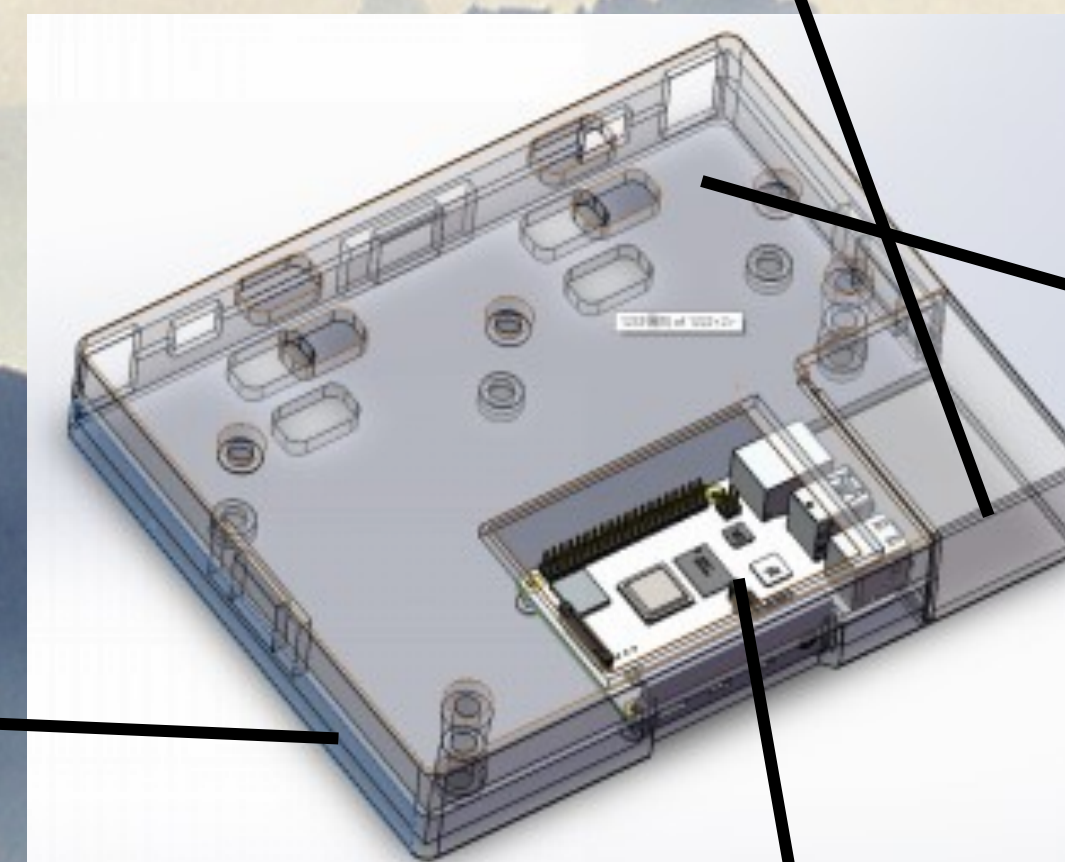

Handgrip case

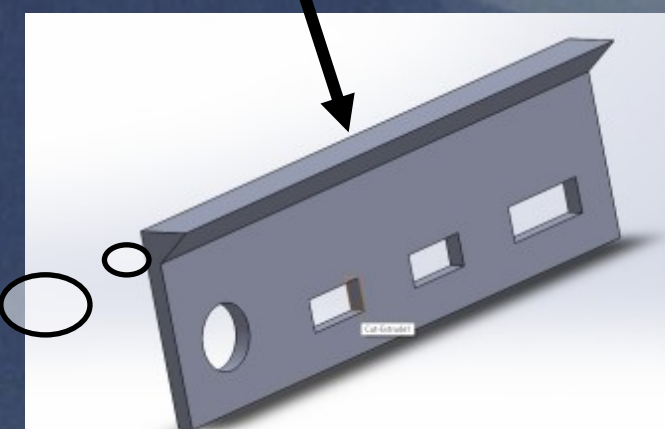

USB access port



Raspberry Pi 4

Raspberry Pi is a series of small single-board computers developed in the United Kingdom by the Raspberry Pi Foundation. Early on, the Raspberry Pi project leaned towards the promotion of teaching basic computer science in schools and in developing countries. Later, the original model became far more popular than anticipated, selling outside its target market for uses such as robotics. It is now widely used in many areas.